

# MAT Series

## REFRIGERATED DISPLAY – GRAB & GO



MODEL | MAT370L

### MAT SERIES – REFRIGERATED DISPLAY 3 SHELVES

Display your grab and go items in style while keeping them chilled.

#### CABINET CONSTRUCTION

Heavy duty construction includes a matte black body base with top side double tempered glass.

The interior bottom of the display is made of stainless steel.

#### REFRIGERATION SYSTEM

Environmentally safe R134A refrigerant. Bottom-mounted condensing unit positioned for easy maintenance.

Maintains a temperature range from 2°C to 10°C. Includes automatic defrost setting with a ventilated cooling system.

#### STORAGE

Includes (3) different heights in the bottom of the display.

#### MODEL FEATURES

Brilliant internal LED lighting.

Front glass guard.

### SPECIAL FEATURES

- Brilliant internal LED lighting at 2 side
- Digital temperature control and display
- Adjustable glass shelves
- 4 casters with 2 brakes
- Double tempered glass
- Ventilated cooling system
- Automatic defrost
- Matte black finish
- Night curtain



# MAT Series

## REFRIGERATED DISPLAY – GRAB & GO



MODEL | MAT370L

### TECHNICAL DATA

MODEL	WEIGHT N.W (KG) G.W (KG)	TEMPERATURE	REFRIGERANT	DIMENSIONS-WxDxH		CAPACITY L FT <sup>3</sup>	AMPS	VOLTAGE
				Inches	mm			
MAT370L	157	2°C to 10°C	R134A R290	51-7/8 x 34 x 42	1313 x 865 x 1067	370 13	12.7	110V 60 Hz

### PLAN VIEW

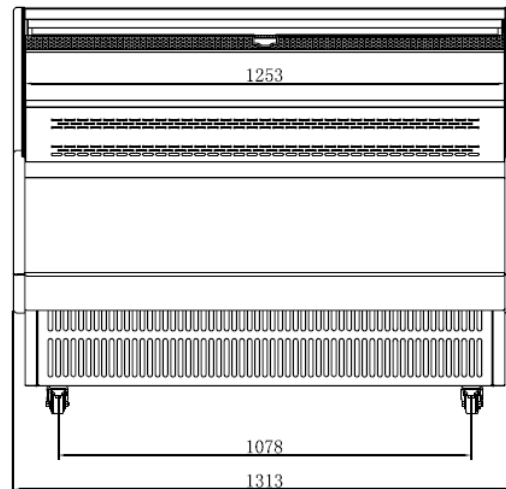
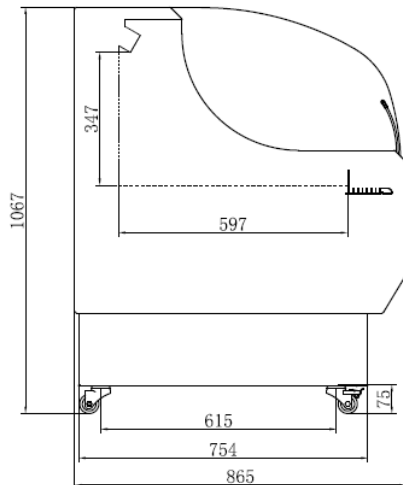

**NOTE :** These merchandisers are designed for use in stores when temperature and humidity do not exceed 24°C and 55% RH. Designed for holding pre-chilled product only.

We reserve the right to change or revise specifications and product design in connection with any feature of our products. Such changes do not entitle the buyer to corresponding changes, improvements, additions, or replacements for equipment previously sold or shipped.